

# AIRPORT LAYOUT PLAN DRAWINGS

## DARE COUNTY REGIONAL AIRPORT (MQI) DARE COUNTY, NORTH CAROLINA

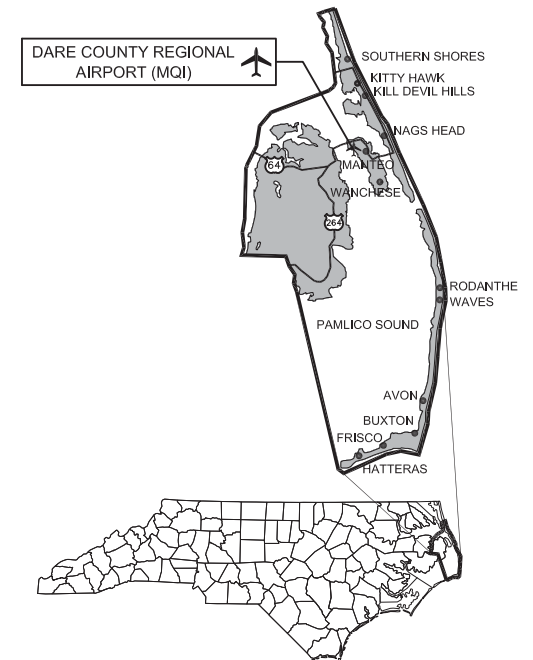

DARE COUNTY, NC



SOURCE: NATIONAL OCEANIC & ATMOSPHERIC ADMINISTRATION (NOAA)  
FEDERAL AVIATION ADMINISTRATION (FAA): FIRST-ORDER WIND OBSERVING STATION  
(VFR/IFR WINDS) - ELIZABETH CITY, NORTH CAROLINA 1992 TO 2001 (10-YEARS)

RUNWAY	CROSSWIND COMPONENT	ALL WEATHER	IFR
5-23	10.5 KNT-12 MPH	92.1%	93.0%
	13.0 KNT-15 MPH	95.7%	96.2%
17-35	10.5 KNT-12 MPH	85.1%	86.8%
	13.0 KNT-15 MPH	91.7%	92.3%
COMBINED	16.0 KNT-20 MPH	97.2%	96.6%
	10.5 KNT-12 MPH	97.4%	97.3%
	13.0 KNT-15 MPH	99.1%	99.0%
	16.0 KNT-20 MPH	99.7%	99.6%

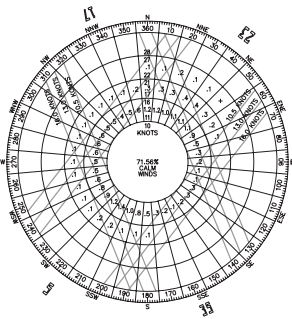

ALL WEATHER WIND ROSE

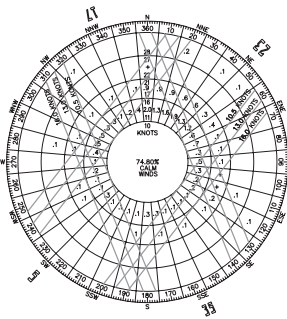

IFR WIND ROSE

- SHEET NO. 1 AIRPORT LAYOUT DRAWING
- SHEET NO. 2 AIRPORT AIRSPACE DRAWING
- SHEET NO. 3 INNER APPROACH DRAWING (RUNWAY 5 END)
- SHEET NO. 4 INNER APPROACH DRAWING (RUNWAY 23 END)
- SHEET NO. 5 INNER APPROACH DRAWING (RUNWAY 17 END)
- SHEET NO. 6 INNER APPROACH DRAWING (RUNWAY 35 END)
- SHEET NO. 7 OBSTRUCTION DATA SHEET
- SHEET NO. 8 TERMINAL AREA DRAWING
- SHEET NO. 9 LAND USE DRAWING
- SHEET NO. 10 AIRPORT PROPERTY MAP

JUNE 2006

NCDOT.DOA PROJECT NO.: 36237.35.3.2 & 36244.46.1.2  
TBI PROJECT NO.: 2301-0402



FAA / NCDOT  
REVIEW DRAWING - 6/2006



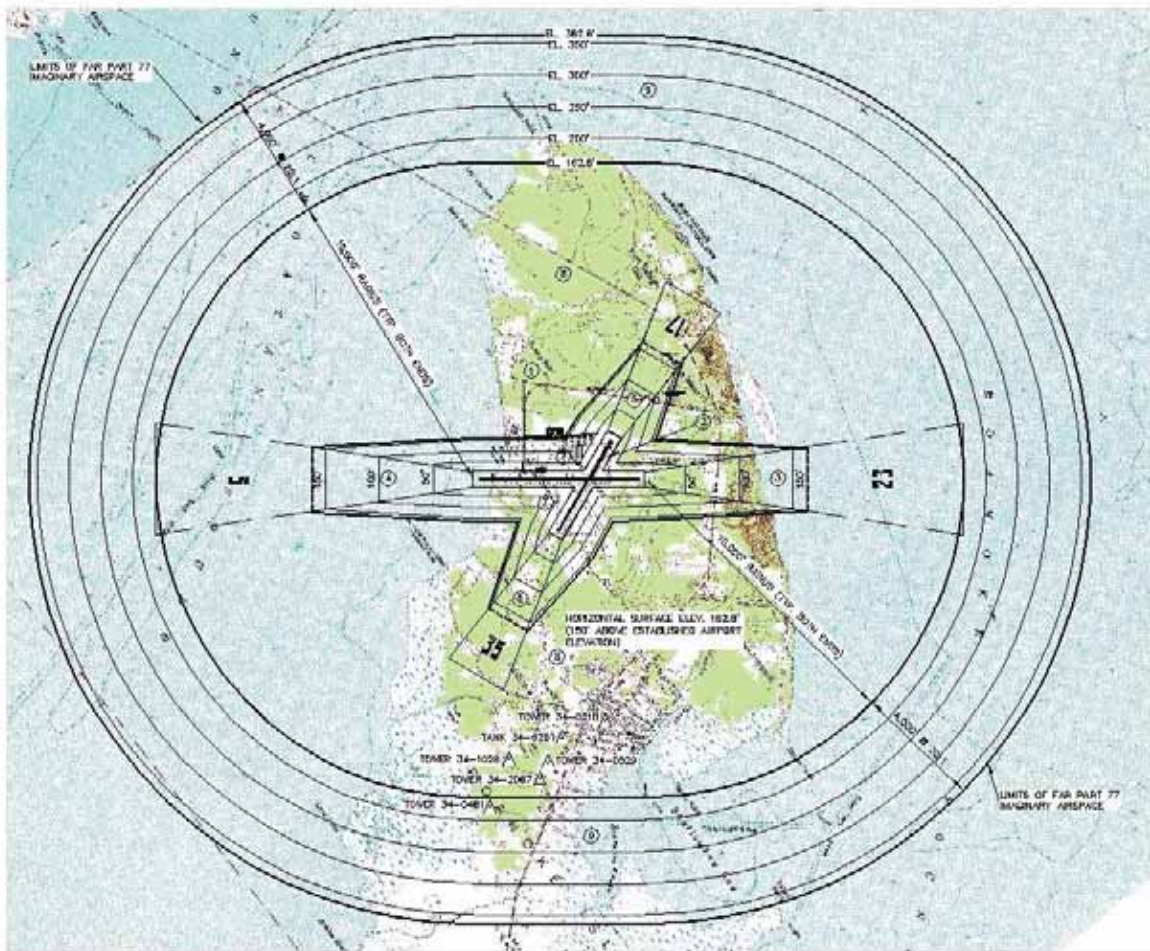

DIGITAL BASE MAPPING FROM USGS 7.5 MINUTE QUADRANGLE MAPS  
BLOCK 35075, MANTLE, WANDNESE, MANN'S HARBOR

FAR PART 77 OBSTRUCTION TABLE			
FAA TOWER NO.	DESCRIPTION	TOWER AGL ELEV. (MSL)	CLEARANCE (E/U)
34-0218	TOWER	182.8'	± 135.2' CLEARANCE
34-0461	TOWER	182.8'	± 30.5' CLEARANCE
34-0523	TOWER	182.8'	± 48.2' CLEARANCE
34-1028	TOWER	182.8'	± 37.2' CLEARANCE
34-2067	TOWER	182.8'	± 135.2' CLEARANCE
34-0261	TANK	182.8'	± 25.8' CLEARANCE

SOURCE: TOWER OBSTRUCTION DATA FROM NATIONAL AERONAUTICAL CHARTING OFFICE, DIGITAL DIGESTIBLE FILE (2006).

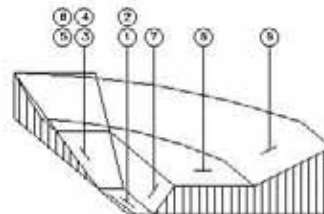

ISOMETRIC SECTIONAL VIEW OF  
CFR PART 77 IMAGINARY SURFACES

NOT TO SCALE

FAA / NCOAA  
REVIEW DRAWING - 602006

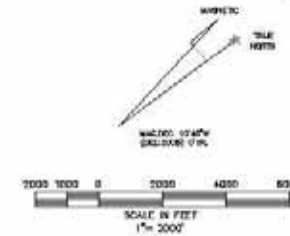

CFR PART 77 IMAGINARY SURFACES

- |  |   |
|--|---|
| ① PRIMARY SURFACE- RUNWAY 5-23<br>(2,102' X 5,000'), SAME ELEVATION AS RUNWAY  | ③ RUNWAY 17 APPROACH SURFACE<br>500' X 5,000' X 2,000'<br>20:1 APPROACH SLOPE |
| ② PRIMARY SURFACE- RUNWAY 17-35<br>(1,703' X 500'), SAME ELEVATION AS RUNWAY   | ④ RUNWAY 35 APPROACH SURFACE<br>300' X 5,000' X 2,000'<br>20:1 APPROACH SLOPE |
| ③ RUNWAY 23 APPROACH SURFACE<br>300' X 10,000' X 3,500'<br>34:1 APPROACH SLOPE | ⑤ 7:1 TRANSITIONAL SURFACE  |
| ④ RUNWAY 5 APPROACH SURFACE<br>500' X 10,000' X 3,500'<br>34:1 APPROACH SLOPE  | ⑥ HORIZONTAL SURFACE - 150' ABOVE<br>ESTABLISHED AIRPORT ELEVATION            |
|  | ⑦ 20:1 GENERAL SURFACE  |

RUNWAY DATA

RUNWAY	ELEVATION	LENGTH	LATITUDE	LONGITUDE	GRADE TO AZIMUTH
5 (U)	8.9'	5,000'	35 54'45.62"	75 42'07.21"	57 28'55.056"
23 (U)	12.4'		35 55'24.95"	75 41'23.74"	237 30'23.738"
17 (U)	12.8'	3,300'	35 55'25.22"	75 41'47.98"	156 00'43.40"
35 (U)	8.6'		38 24'24.84"	75 41'32.96"	338 00'52.31"

AIRPORT REFERENCE POINT (ARP-U)  
LATITUDE NORTH (U): 35 55'07.02"  
LONGITUDE WEST (U): 75 41'45.23"  
ESTABLISHED AIRPORT ELEVATION (U): 18.8' MSL

DATA/AIRSPACE NOTES

- ALL EXISTING AND FUTURE STRUCTURES SHOULD REMAIN CLEAR OF THE PLANNED CFR PART 77 IMAGINARY SURFACES.
- COUNTY HAS ADOPTED AN ORDINANCE TO REGULATE HEIGHT OF OBJECTS OVER FIFTY (50) FEET TALL AROUND THE DARE COUNTY REGIONAL AIRPORT, DATED MARCH 2005.
- REFER TO THE INNER PORTION OF THE APPROACH SURFACE DRAWINGS AND OBSTRUCTION DATA SHEET FOR CLOSE-IN OBSTRUCTIONS.
- GEODEIC DATA PER FAA DATA BASE, NOS SURVEY 2/23/80. ELEVATIONS ARE IN FEET BASED ON MEAN SEA LEVEL (MSL). HORIZONTAL DATUM IS NAD 83. VERTICAL DATUM IS NAVD 88.

TALBERT & BRIGHT  
ENGINEERING & ARCHITECTURE

4102 BALLEW DR. WAREHOUSES, NC 28587  
PHONE: 919.742.0000 FAX: 919.742.0001  
WWW: www.tbab.com

DARE COUNTY REGIONAL AIRPORT (MS)  
MANTLE, NORTH CAROLINA  
AIRPORT AIRSPACE DRAWING

Approved By:

Title:

Date:

Scale:

Drawn:

Checked:

Project No.:

Sheet No.:

FAA / NCDOT  
REVIEW DRAWING - 6/2006

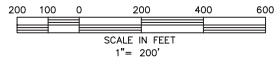

- | AIRPORT BUILDINGS             | AIRPORT FACILITIES                              |
|-------------------------------|---|
| ① TERMINAL                    | Ⓐ NON-DIRECTIONAL RADIO BEACON (NDB)            |
| ② HANGAR (TRANSIENT)          | Ⓑ ROTATING BEACON                               |
| ③ COMMON HANGAR(S)            | Ⓒ AUTOMATED WEATHER OBSERVING SYSTEM (AWOS III) |
| ④ T-HANGAR(S)                 | Ⓓ SEGMENTED CIRCLE AND LIGHTED WIND CONE        |
| ⑤ UNIT HANGAR(S)              | Ⓔ PRECISION APPROACH PATH INDICATOR (PAPI)      |
| ⑥ MAINTENANCE EQUIPMENT BLD.  | Ⓕ RUNWAY END IDENTIFIER LIGHTS (REL)            |
| ⑦ ELECTRICAL VAULT/FIRE TRUCK | Ⓖ FUEL FACILITIES                               |
| ⑧ PAVILION                    | Ⓗ LOCALIZER ANTENNA                             |
|                               | Ⓘ TVOR  |

FAR PART 77  
APPROACH  
SURFACE (U)

FAR PART 77  
APPROACH  
SURFACE (U)

ARRIVAL/  
DEPARTURE  
RPZ (U)

CROATAN  
SOUND

RUNWAY 5 PLAN VIEW  
SCALE: 1"=200'

SEE SHEET #7 FOR OBSTRUCTION INFORMATION

CROATAN SOUND

GROUND PROFILE ALONG EXTENDED RUNWAY CENTERLINE

RUNWAY 5 END

RUNWAY 5 PROFILE  
SCALE:  
1"=200' HORIZONTAL  
1"=20' VERTICAL

OBSTRUCTION DATA FROM:  
FIELD SURVEY - AIKEN & YELLE, JULY, 2003  
AERIAL SURVEY - CAROLINA RESOURCE MAPPING, APRIL 2005

**TALBERT & BRIGHT**  
ENGINEERING & PLANNING CONSULTANTS  
4810 SHELLY DRIVE WILMINGTON, NC 28405  
PHONE: 910.763.5350 FAX: 910.762.0281  
EMAIL: tbright@tbright.com

REVISION	DESCRIPTION	DATE

DARE COUNTY REGIONAL AIRPORT (MCI)  
MANTEO, NORTH CAROLINA  
INNER APPROACH DRAWING  
(RUNWAY 5 END)

Approved By	Title
Date	
DARE COUNTY REGIONAL AIRPORT AUTHORITY	
Date	JUNE 2006
Scale	PER VIEW
Drawn	LSM
Checked	WSB
Project No.	2301-0402
Sheet No.	

3

TEN

FAA / NCDCA  
REVIEW DRAWING - 6/2006

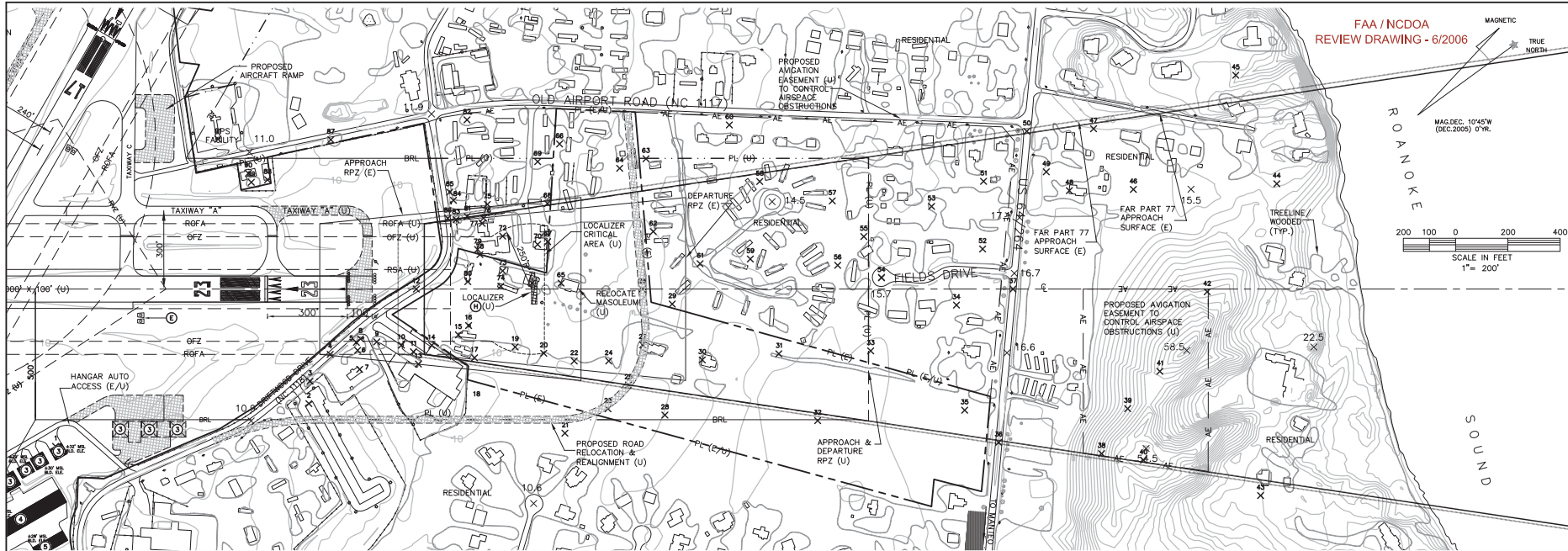
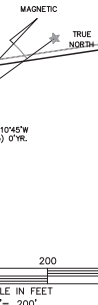

RUNWAY 23 PLAN VIEW  
SCALE: 1"=200'

- AIRPORT BUILDINGS**
- ① TERMINAL
  - ② HANGAR (TRANSIENT)
  - ③ COMMON HANGAR(S)
  - ④ T-HANGAR(S)
  - ⑤ UNIT HANGAR(S)
  - ⑥ MAINTENANCE EQUIPMENT BLD.
  - ⑦ ELECTRICAL VAULT/FIRE TRUCK
  - ⑧ PAVILION
- AIRPORT FACILITIES**
- Ⓐ NON-DIRECTIONAL RADIO BEACON (NDB)
  - Ⓑ ROTATING BEACON
  - Ⓒ AUTOMATED WEATHER OBSERVING SYSTEM (AWOS III)
  - Ⓓ SEGMENTED CIRCLE AND LIGHTED WIND CONE
  - Ⓔ PRECISION APPROACH PATH INDICATOR (PAPI)
  - Ⓕ RUNWAY END IDENTIFIER LIGHTS (REL)
  - Ⓖ FUEL FACILITIES
  - Ⓗ LOCALIZER ANTENNA
  - Ⓘ TVOR

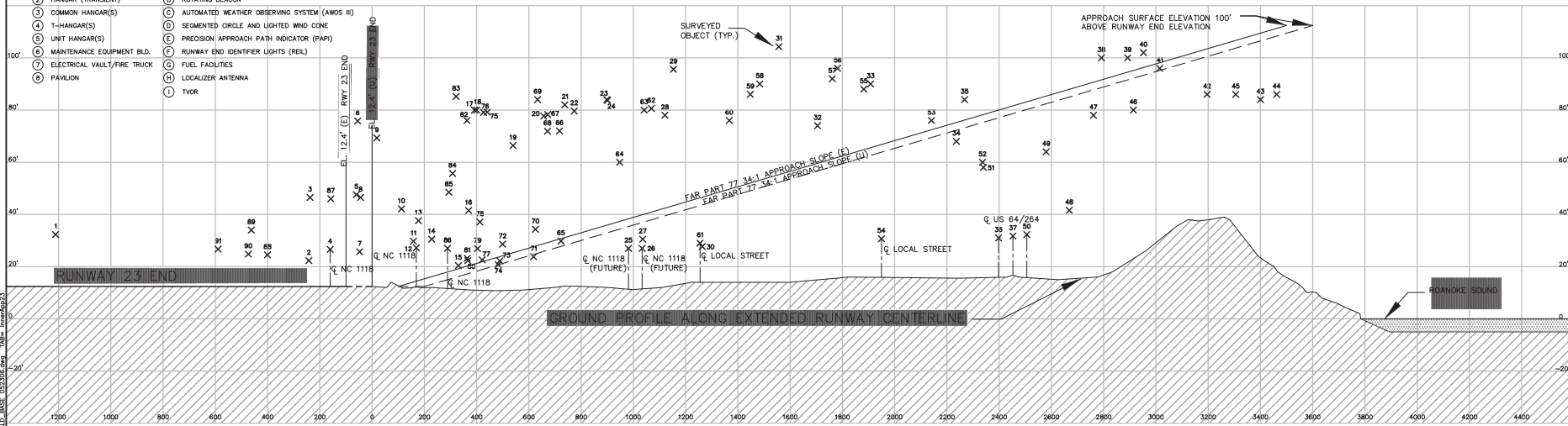

RUNWAY 23 PROFILE  
SCALE: 1"=200' HORIZONTAL  
1"=20' VERTICAL

OBSTRUCTION DATA SOURCES:  
FIELD SURVEY- AIKEN & YELLE, JULY, 2003  
AERIAL SURVEY- CAROLINA RESOURCE MAPPING, APRIL 2005

**TALBERT & BRIGHT**  
ENGINEERING & PLANNING CONSULTANTS  
4810 SHELLY DRIVE WILMINGTON, NC 28405  
PHONE: 910.763.5350 FAX: 910.762.0281  
EMAIL: dtalbert@tbbr.com

REVISION	DESCRIPTION	DATE

DARE COUNTY REGIONAL AIRPORT (MCI)  
MANTEO, NORTH CAROLINA  
INNER APPROACH DRAWING  
(RUNWAY 23 END)

Approved By	
Date	
DARE COUNTY REGIONAL AIRPORT AUTHORITY	
Date	JUNE 2006
Scale	AS SHOWN
Drawn	LSM
Checked	WSB
Project No.	2301-0402
Sheet No.	

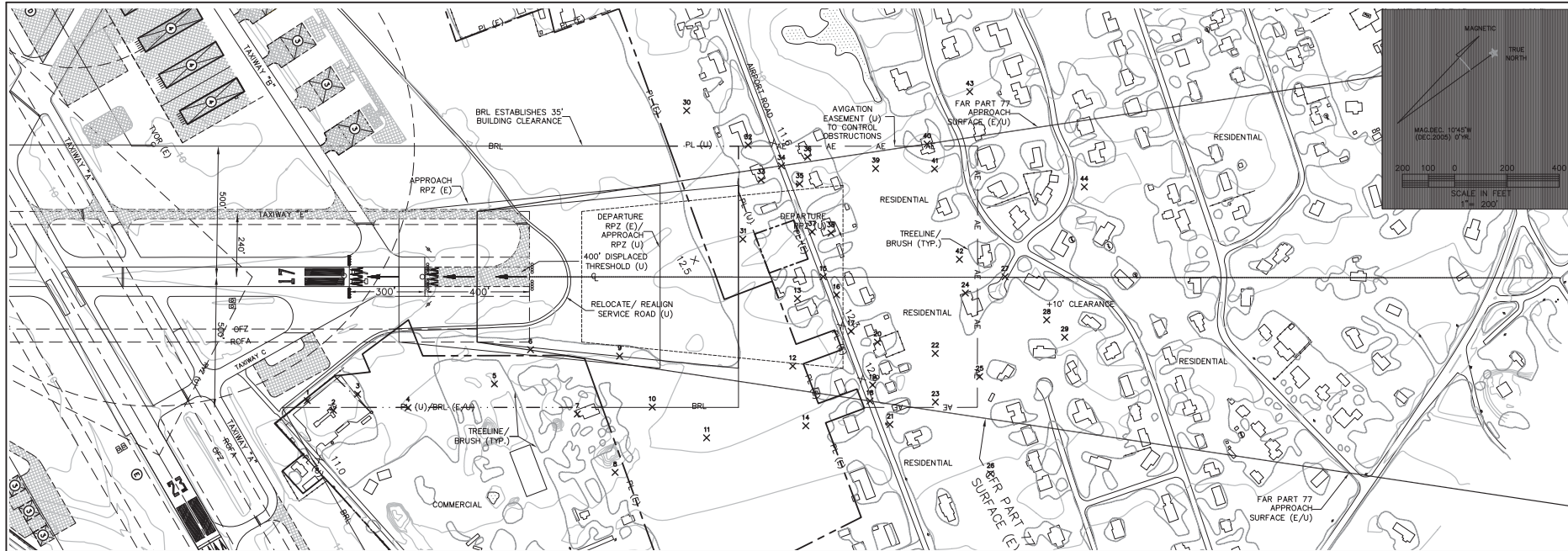

**RUNWAY 17 PLAN VIEW**  
SCALE: 1"=200'

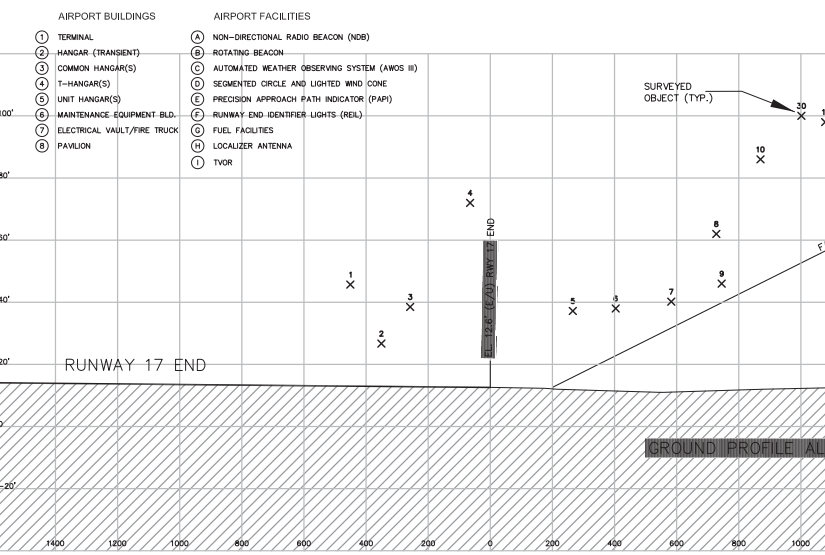

**RUNWAY 17 PROFILE**  
SCALE:  
1"=200' HORIZONTAL  
1"=20' VERTICAL

**OBSTRUCTION DATA SOURCES:**  
FIELD SURVEY— AIKEN & YELLE, JULY, 2003  
AERIAL SURVEY— CAROLINA RESOURCE MAPPING, APRIL 2005

**FAA / NCDCA  
REVIEW DRAWING - 6/2006**

**TALBERT & BRIGHT**  
ENGINEERING & PLANNING CONSULTANTS  
4810 SHELLEY DRIVE WILMINGTON, NC 28405  
PHONE: 910.763.5350 FAX: 910.762.0281  
EMAIL: [tbair@tbair.com](mailto:tbair@tbair.com)

REV#	DESCRIPTION	DATE

**DARE COUNTY REGIONAL AIRPORT (MOI)  
MANTEO, NORTH CAROLINA  
INNER APPROACH DRAWING  
(RUNWAY 17 END)**

Approved By	
Title	
Date	
DARE COUNTY REGIONAL AIRPORT AUTHORITY	
Date	JUNE 2006
Scale	AS SHOWN
Drawn	LSM
Checked	JPS
Project No.	2301-0402
Sheet No.	

FAA / NCOA  
REVIEW DRAWING - 6/2006

**TALBERT & BRIGHT**  
ENGINEERING & PLANNING CONSULTANTS  
4810 SHELLEY DRIVE WILMINGTON, NC 28405  
PHONE: 910.763.5350 FAX: 910.762.0281  
EMAIL: [tb@talbertbright.com](mailto:tb@talbertbright.com)

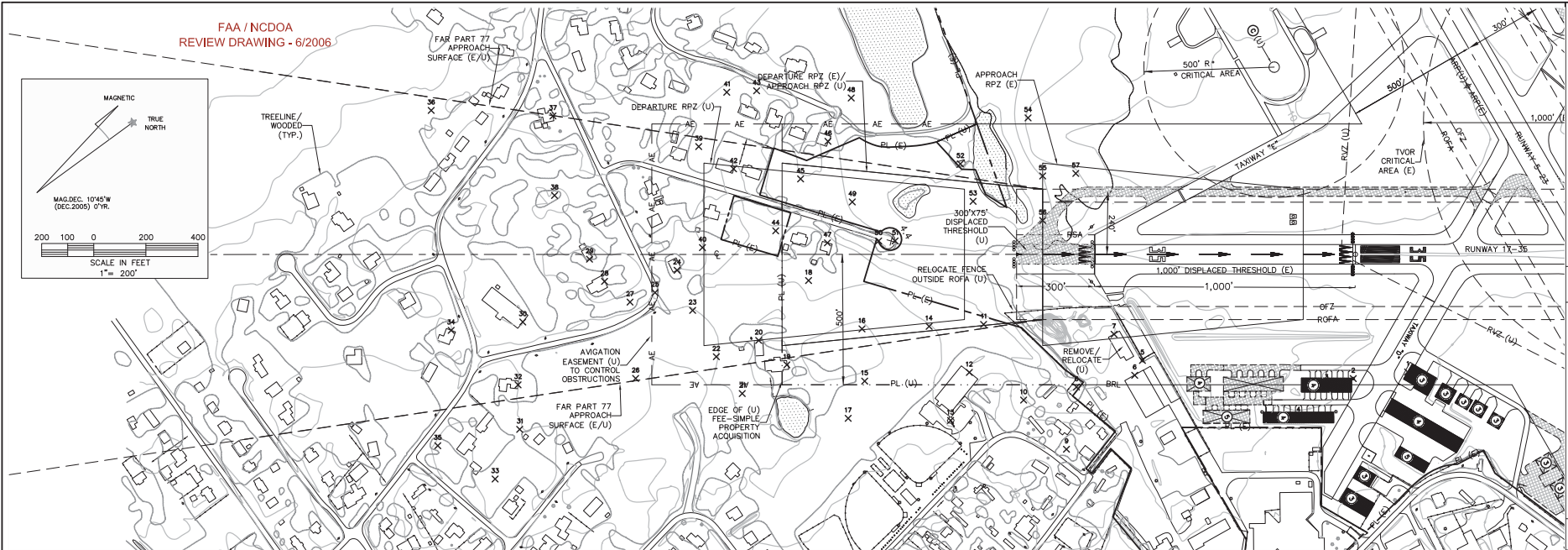
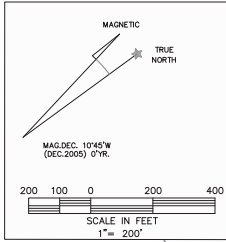

RUNWAY 35 PLAN VIEW  
SCALE: 1"=200'

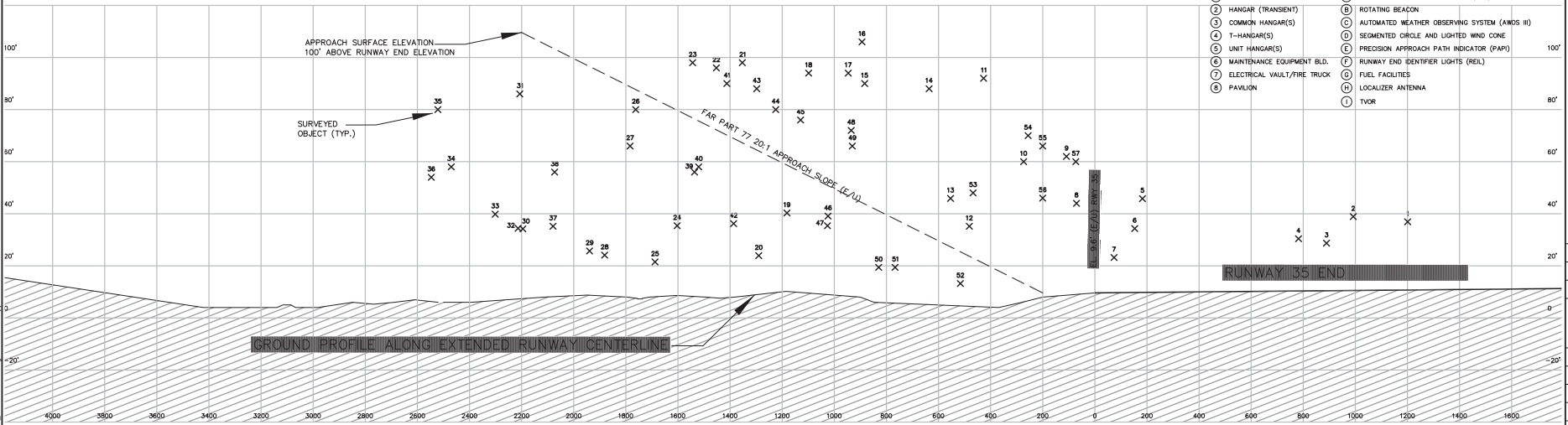

RUNWAY 35 PROFILE  
SCALE: 1"=200' HORIZONTAL  
1"=20' VERTICAL

OBSTRUCTION DATA SOURCES:  
FIELD SURVEY- AIKEN & YELLE, JULY, 2003  
AERIAL SURVEY- CAROLINA RESOURCE MAPPING, APRIL 2005

- | AIRPORT BUILDINGS               |   | AIRPORT FACILITIES                                |                       |
|---------------------------------|---|---|-----------------------|
| (1) TERMINAL                    | (A) NON-DIRECTIONAL RADIO BEACON (NDB)            | (4) AUTOMATED WEATHER OBSERVING SYSTEM (AWOS III) | (C) FUEL FACILITIES   |
| (2) HANGAR (TRANSIENT)          | (B) ROTATING BEACON                               | (5) SEGMENTED CIRCLE AND LIGHTED WIND CONE        | (D) LOCALIZER ANTENNA |
| (3) COMMON HANGAR(S)            | (C) AUTOMATED WEATHER OBSERVING SYSTEM (AWOS III) | (6) PRECISION APPROACH PATH INDICATOR (PAPI)      | (E) TVOR              |
| (4) T-HANGAR(S)                 | (D) SEGMENTED CIRCLE AND LIGHTED WIND CONE        | (7) RUNWAY END IDENTIFIER LIGHTS (REIL)           |                       |
| (5) UNIT HANGAR(S)              | (E) PRECISION APPROACH PATH INDICATOR (PAPI)      | (8) FUEL FACILITIES                               |                       |
| (6) MAINTENANCE EQUIPMENT BLD.  | (F) RUNWAY END IDENTIFIER LIGHTS (REIL)           | (9) ELECTRICAL VAULT/FIRE TRUCK                   |                       |
| (7) ELECTRICAL VAULT/FIRE TRUCK | (G) FUEL FACILITIES                               | (10) LOCALIZER ANTENNA                            |                       |
| (8) PAVILION                    | (H) FUEL FACILITIES                               | (11) TVOR   |                       |
| (9) PAVILION                    | (I) TVOR  |   |                       |

REVNO	DESCRIPTION	DATE

DARE COUNTY REGIONAL AIRPORT (MCI)  
MANTEO, NORTH CAROLINA  
INNER APPROACH DRAWING  
(RUNWAY 35 END)

Approved By	
Title	
Date	
DARE COUNTY REGIONAL AIRPORT AUTHORITY	
Date	JUNE 2006
Scale	AS SHOWN
Drawn	LSM
Checked	WSB
Project No.	2301-0402
Sheet No.	

**6**  
TEN





M:\2301\6000\0402\A.D. BASE\_0230506.dwg, Title: 100, 12-09-06, 100

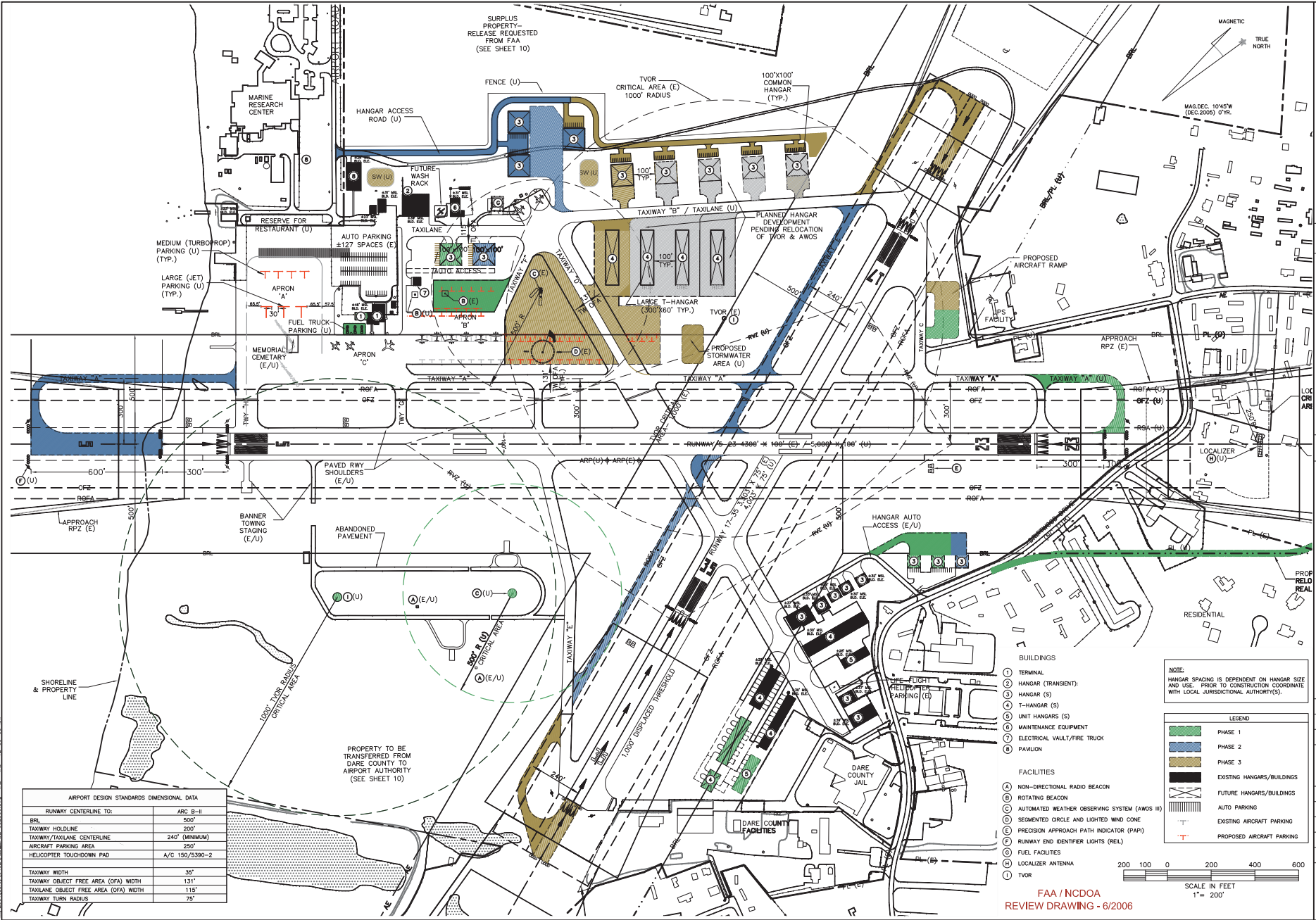

AIRPORT DESIGN STANDARDS DIMENSIONAL DATA	
RUNWAY CENTERLINE TO:	ARC B-II
BRIL	500'
TAXIWAY HOLDLINE	200'
TAXIWAY/TAXILANE CENTERLINE	240' (MINIMUM)
AIRCRAFT PARKING AREA	250'
HELICOPTER TOUCHDOWN PAD	A/C 150/5,590-2
TAXIWAY WIDTH	35'
TAXIWAY OBJECT FREE AREA (OFA) WIDTH	131'
TAXILANE OBJECT FREE AREA (OFA) WIDTH	115'
TAXIWAY TURN RADIUS	75'

**LEGEND**

**PHASE 1** (Green)

**PHASE 2** (Blue)

**PHASE 3** (Yellow)

**EXISTING HANGARS/BUILDINGS** (Black)

**FUTURE HANGARS/BUILDINGS** (Grey)

**AUTO PARKING** (White)

**EXISTING AIRCRAFT PARKING** (Red)

**PROPOSED AIRCRAFT PARKING** (Red)

**FACILITIES**

- (A) NON-DIRECTIONAL RADIO BEACON
- (B) ROTATING BEACON
- (C) AUTOMATED WEATHER OBSERVING SYSTEM (AWOS III)
- (D) SEGMENTED CIRCLE AND LIGHTED WIND CONE
- (E) PRECISION APPROACH PATH INDICATOR (PAPI)
- (F) RUNWAY END IDENTIFIER LIGHTS (REL)
- (G) FUEL FACILITIES
- (H) LOCALIZER ANTENNA
- (I) TVOR

**NOTE:** HANGAR SPACING IS DEPENDENT ON HANGAR SIZE AND USE. PRIOR TO CONSTRUCTION COORDINATE WITH LOCAL JURISDICTIONAL AUTHORITY(S).

**SCALE IN FEET**  
1" = 200'

0 200 400 600

**TALBERT & BRIGHT**  
ENGINEERING & PLANNING CONSULTANTS  
4810 SHELLEY DRIVE WILMINGTON, NC 28405  
PHONE: 910.763.5350 FAX: 910.762.0281  
EMAIL: tbright@tbright.com

**DARE COUNTY REGIONAL AIRPORT (MCI)  
MANTEO, NORTH CAROLINA  
TERMINAL AREA DRAWING**

Approved By: \_\_\_\_\_  
Title: \_\_\_\_\_  
Date: \_\_\_\_\_  
DARE COUNTY REGIONAL AIRPORT AUTHORITY  
Date: JUNE 2006  
Scale: 1" = 200'  
Drawn: LSM/LSW  
Checked: JPS  
Project No.: 2301-0402  
Sheet No.: 8  
TEN



AIRPORT LAND USE LEGEND	
LAND USE CATEGORY	SYMBOL
EXISTING AIRPORT/COUNTY PROPERTY INTERESTS	---
FUTURE AIRPORT/COUNTY PROPERTY INTERESTS	---
AIRPORT LEASEHOLD	---/---
DARE COUNTY LAND	---
AIRPORT AUTHORITY FEE SIMPLE LAND	---

FAA / NCDOT  
REVIEW DRAWING - 6/2006



MAG. DEC. 10°45'W  
(DEC. 2005) 0°YR.

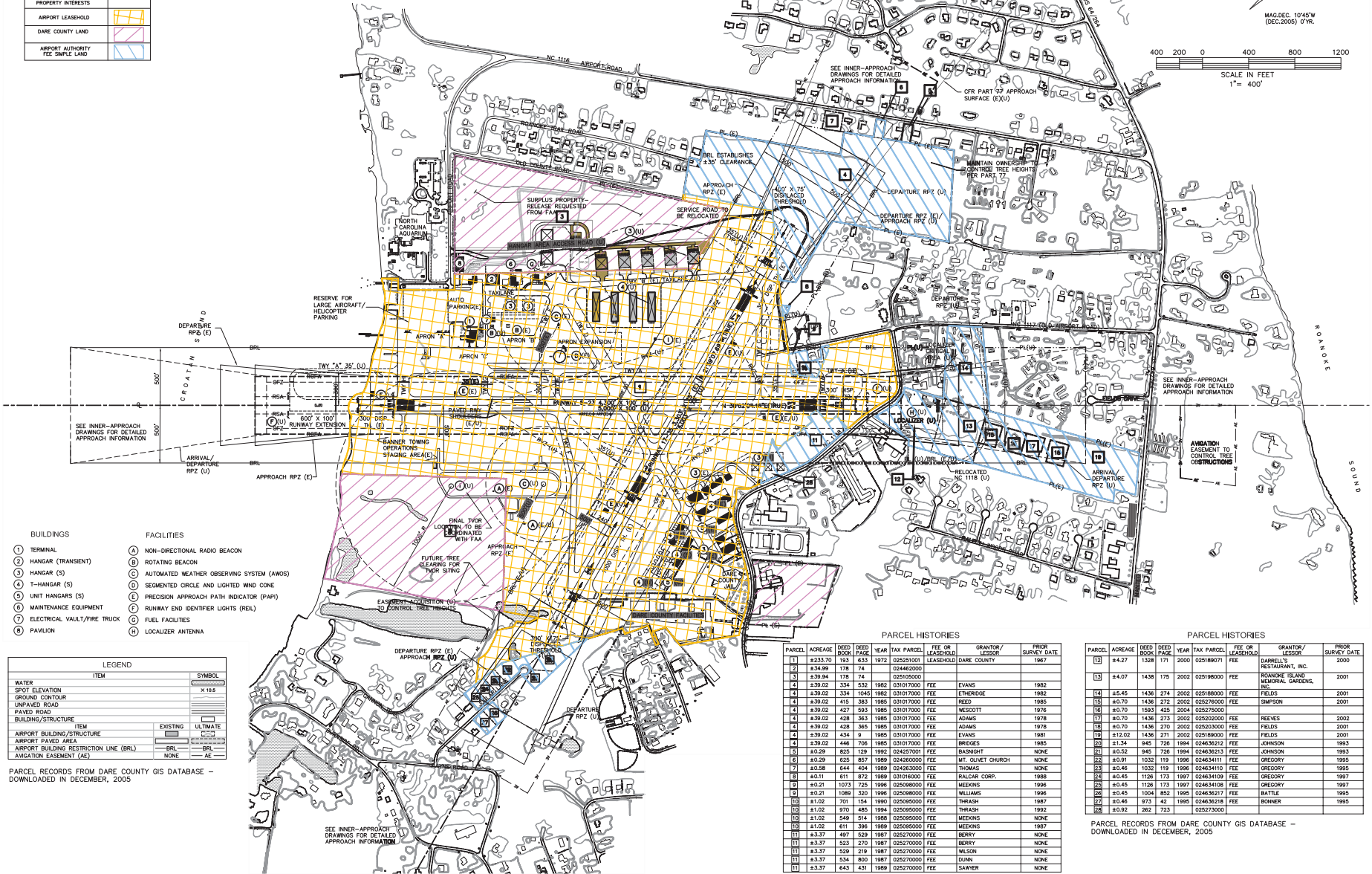
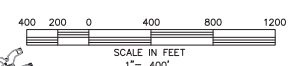

- |                               |   |
|-------------------------------|---|
| <b>BUILDINGS</b>              | <b>FACILITIES</b>                           |
| ① TERMINAL                    | A NON-DIRECTIONAL RADIO BEACON              |
| ② HANGAR (TRANSIT)            | B ROTATING BEACON                           |
| ③ HANGAR (S)                  | C AUTOMATED WEATHER OBSERVING SYSTEM (AWOS) |
| ④ T-HANGAR (S)                | D SEGMENTED CIRCLE AND LIGHTED WIND CONE    |
| ⑤ UNIT HANGARS (S)            | E PRECISION APPROACH PATH INDICATOR (PAPI)  |
| ⑥ MAINTENANCE EQUIPMENT       | F RUNWAY END IDENTIFIER LIGHTS (REL)        |
| ⑦ ELECTRICAL VAULT/FIRE TRUCK | G FUEL FACILITIES                           |
| ⑧ PAVILION                    | H LOCALIZER ANTENNA                         |

LEGEND	SYMBOL
WATER	---
SPOT ELEVATION	x 10.8
GROUND CONTOUR	---
UNPAVED ROAD	---
PAVED ROAD	---
BUILDING/STRUCTURE	---
ITEM	EXISTING ULTIMATE
AIRPORT BUILDING/STRUCTURE	---
AIRPORT PAVED AREA	---
AIRPORT BUILDING RESTRICTION LINE (BRL)	---
AVIATION EASEMENT (AE)	---

PARCEL RECORDS FROM DARE COUNTY GIS DATABASE -  
DOWNLOADED IN DECEMBER, 2005

PARCEL HISTORIES

PARCEL	ACREAGE	DEED BOOK PAGE	DEED DATE	YEAR	TAX PARCEL ID	FEE OR LEASEHOLD	GRANTOR/LESSOR	PRIOR SURVEY DATE
1	233.70	183	1333	1972	022521001	LEASEHOLD	DARE COUNTY	1967
2	234.99	178	74		024462000			
3	239.94	178	74		025105000			
4	239.02	334	1045	1982	031077000	FEE	EVANS	1982
4	239.02	415	383	1985	031077000	FEE	REED	1985
4	239.02	427	583	1985	031077000	FEE	HESCOTT	1978
4	239.02	428	363	1985	031077000	FEE	ADAMS	1978
4	239.02	428	365	1985	031077000	FEE	ADAMS	1978
4	239.02	434	1	1985	031077000	FEE	EVANS	1981
4	239.02	446	706	1985	031077000	FEE	BRIDGES	1985
5	20.29	825	129	1992	024257001	FEE	BANINGHT	NONE
6	20.29	825	857	1989	024260000	FEE	MT. OLIVET CHURCH	NONE
7	21.98	445	404	1989	024263000	FEE	THOMAS	NONE
8	20.11	611	872	1989	031061000	FEE	RALCAR CORP.	1988
9	20.21	1073	725	1996	025098000	FEE	MEKINS	1998
9	20.21	1089	320	1996	025099000	FEE	WILLIAMS	1996
10	21.02	701	154	1990	025096000	FEE	THRASH	1987
10	21.02	970	485	1994	025095000	FEE	THRASH	1992
10	21.02	549	134	1988	025095000	FEE	MEKINS	NONE
10	21.02	611	396	1989	025095000	FEE	MEKINS	1987
11	23.37	497	529	1987	025270000	FEE	BERRY	NONE
11	23.37	523	270	1987	025270000	FEE	BERRY	NONE
11	23.37	529	219	1987	025270000	FEE	WILSON	NONE
11	23.37	534	800	1987	025270000	FEE	DUNN	NONE
11	23.37	643	431	1989	025270000	FEE	SAWER	NONE

PARCEL HISTORIES

PARCEL	ACREAGE	DEED BOOK PAGE	DEED DATE	YEAR	TAX PARCEL ID	FEE OR LEASEHOLD	GRANTOR/LESSOR	PRIOR SURVEY DATE
13	24.27	1328	171	2000	025189071	FEE	DARRILL'S RESTAURANT, INC.	2000
13	24.07	1438	175	2002	025198000	FEE	MEMORIAL GARDENS,	2001
14	25.45	1436	274	2002	025188000	FEE	FIELDS	2001
15	20.70	1436	272	2002	025276000	FEE	SIMPSON	2001
16	20.70	13503	425	2004	025275000	FEE		2001
17	20.70	1436	273	2002	025203000	FEE	REMS	2002
18	20.70	1436	270	2002	025203000	FEE	FIELDS	2001
19	21.02	1436	271	2002	025204000	FEE	FIELDS	2001
20	21.24	945	726	1994	024636212	FEE	JOHNSON	1993
21	20.52	945	726	1994	024636213	FEE	JOHNSON	1993
22	20.91	1032	119	1996	024634111	FEE	GREGORY	1995
23	20.46	1032	119	1996	024634110	FEE	GREGORY	1995
24	20.45	1126	173	1997	024634109	FEE	GREGORY	1997
25	20.45	1126	173	1997	024634108	FEE	GREGORY	1997
26	20.45	1304	852	1995	024636217	FEE	BATTLE	1995
27	20.46	973	42	1995	024636216	FEE	BONNER	1995
28	20.92	262	723		025273000			

PARCEL RECORDS FROM DARE COUNTY GIS DATABASE -  
DOWNLOADED IN DECEMBER, 2005

**TALBERT & BRIGHT**  
ENGINEERING & PLANNING CONSULTANTS  
4810 SHELLEY DRIVE WILMINGTON, NC 28405  
PHONE: 910.763.6300 FAX: 910.762.0281  
EMAIL: tbright@tbright.com

REVISION	DESCRIPTION	DATE

DARE COUNTY REGIONAL AIRPORT (MCI)  
MANTEO, NORTH CAROLINA  
AIRPORT PROPERTY MAP

Approved By \_\_\_\_\_  
Title \_\_\_\_\_  
Date \_\_\_\_\_

DARE COUNTY REGIONAL AIRPORT AUTHORITY

Date \_\_\_\_\_  
Scale 1" = 400'  
Drawn \_\_\_\_\_  
Checked \_\_\_\_\_  
Project No. \_\_\_\_\_  
Sheet No. 2301-0402

10

TEN

M:\2301\0402\10.DWG BASE 02/23/06.tbm PlotAreaMap 12-08-05